



Type VUI check valves

- Poppet type

Technical specifications and diagrams are measured with mineral oil of 46 cSt viscosity at 40°C (104°F) temperature.

	VUI 38	VUI 38/HF	VUI 12	VUI 34	VUI 100
Nominal flow	25 l/min (6.6 US gpm)	40 l/min (10.6 US gpm)	40 l/min (10.6 US gpm)	100 l/min (26.4 US gpm)	160 l/min (42.3 US gpm)
Max. pressure	400 bar (5800 psi)	300 bar (4350 psi)	400 bar (5800 psi)	400 bar (5800 psi)	400 bar (5800 psi)
Oil leakage	0.25 cm ³ /min (0.015 in ³ /min) at 210 bar (3050 psi)				
Fluid	mineral based oil				
Viscosity	from 10 to 200 cSt				
Max. level of contamination	18/16/13 ISO4406				
Fluid temperature	with NBR seals: from -20°C (-4°F) to 80°C (176°F)				
Environmental temperature for working conditions	from -40°C (-40°F) to 100°C (212°F)				
Weight	Steel 0.08 kg (0.18 lb)	0.075 kg (0.16 lb)	0.15 kg (0.33 lb)	0.30 kg (0.66 lb)	0.54 kg (1.19 lb)

NOTE - For different conditions, please contact Walvoil Sales Dpt.



Dimensions

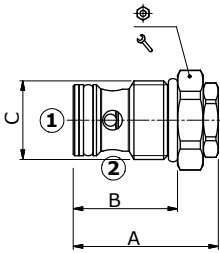

Dimensions are in mm-in

Valve type	A	B	C	\varnothing	Nm-lbft
VUI 38	42-1.65	27-1.06	M20x1.5	24	40-29
VUI 38/HF	34.5 - 1.36	28 - 1.10	M22x1.5	27	50-37
VUI 12	48-1.89	34.5-1.36	M26x1.5	30	60-44
VUI 34	68-2.68	51-2.01	M33x2	38	70-51
VUI 100	75-2.95	54.5-2.14	M42x2	46	80-59

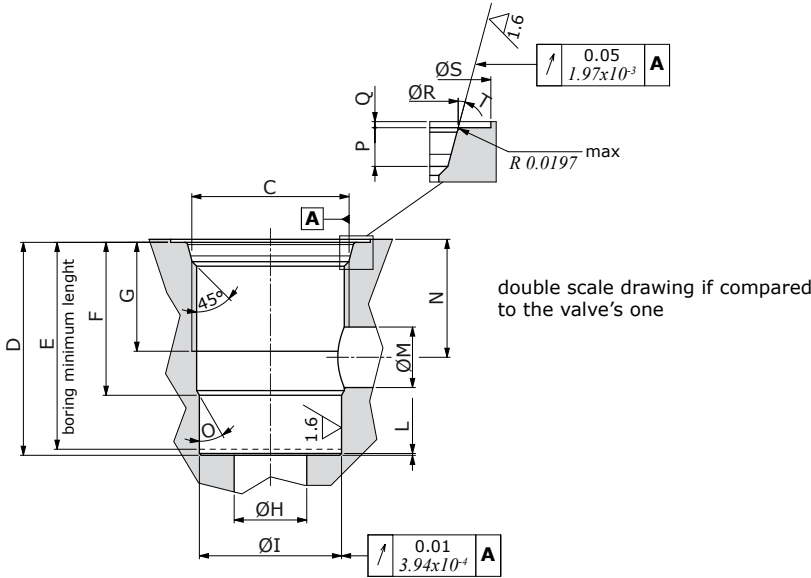

Dimensions are in mm-in

Valve cavity for	C	D	E	F	G	\varnothing H	\varnothing I	L	\varnothing M	N	O	P	Q	\varnothing R	\varnothing S
VUI 38	M20x1.5	29.5 1.16	28 1.10	20.5 0.81	16 0.63	10 0.39	16 H9 0.630 H9	/	7 0.275	16 0.63	30°	3 0.118	0.5 0.020	21 0.83	30 1.18
VUI 12	M26x1.5	35.2 1.39	34.2 1.35	25.3 0.996	18 0.71	12 0.47	23.5 H9 0.925 H9	0.3x45° 0.012x45°	10 0.39	19.5 0.77	30°	3.2 0.126	0.5 0.020	27.6 1.09	33 1.30
VUI 34	M33x2	52.5 2.07	51.5 2.03	39 1.54	28 1.10	20 0.79	27 H9 1.063 H9	0.5x45° 0.020x45	15 0.59	29.5 1.16	20°	3.2 0.126	0.5 0.020	34 1.35	40 1.57
VUI 100	75-2.95	57 2.24	55 2.17	41 1.61	29 1.14	28 1.10	38 H9 1.496 H9	1.5x45° 0.059x45	18 0.71	30 1.18	30°	4.5 0.177	0.5 0.020	43.5 1.71	50 1.97

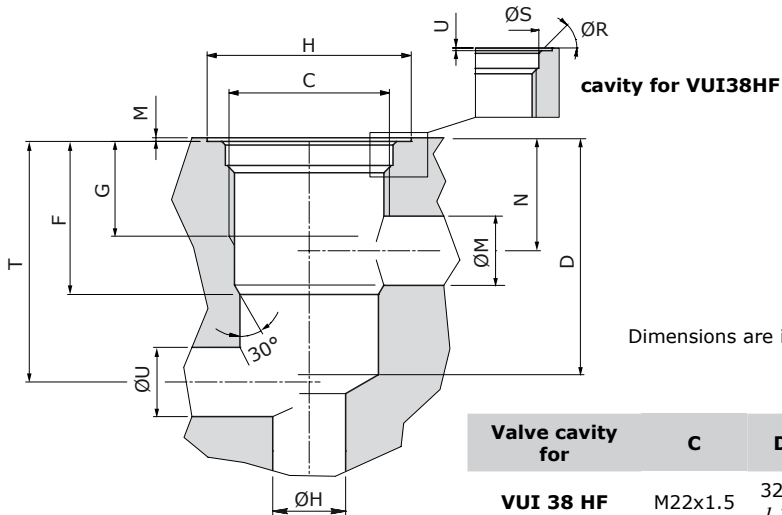

Valve cavity for	C	D	F	G	\varnothing H	\varnothing M	N	T	\varnothing U
VUI 38 HF	M22x1.5	32.5 1.28	21 0.83	15 0.59	max. 18 max. 0.71	max.9 max. 0.35	15.5 0.61	33 1.30	9.5 0.37

Ordering codes and description composition

VUI 38/Pa0,5

1

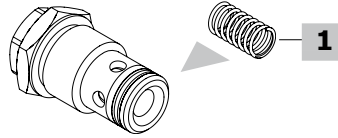

VUI complete valves

TYPE	CODE	DESCRIPTION
VUI 38/Pa0,5	1300020400	Steel body, opening pressure 0.5 bar (7.25 psi)
VUI 38/HF/Pa0,5	1300020900	Steel body, opening pressure 0.5 bar (7.25 psi)
VUI 12/Pa0,5	1300030400	Steel body, opening pressure 0.5 bar (7.25 psi)
VUI 34/Pa0,5	1300040400	Steel body, opening pressure 0.5 bar (7.25 psi)
VUI 100/Pa0,5	1300050400	Steel body, opening pressure 0.5 bar (7.25 psi)

For configurations with FPM (Viton) seals please contact our Sales Dpt.

1 Pressure setting springs

TYPE	CODE	DESCRIPTION
For VUI 38 valve		
Pa0,5	3ML1072001	Opening pressure 0.5 bar (7.25 psi)
Pa5	3ML1072003	Opening pressure 5 bar (72.5 psi)
For VUI 38 HF valve		
Pa0,5	1300020900	Opening pressure 0.5 bar (7.25 psi)
For VUI 12 valve		
Pa0,5	3ML1112900	Opening pressure 0.5 bar (7.25 psi)
Pa5	3ML1102801	Opening pressure 5 bar (72.5 psi)
For VUI 34 valve		
Pa0,5	3ML1155200	Opening pressure 0.5 bar (7.25 psi)
Pa5	3ML1155000	Opening pressure 5 bar (72.5 psi)
For VUI 100 valve		
Pa0,5	3ML1172801	Opening pressure 0.5 bar (7.25 psi)
Pa5	3ML1172800	Opening pressure 5 bar (72.5 psi)

Rating diagrams

VUI 38 pressure drop vs. flow

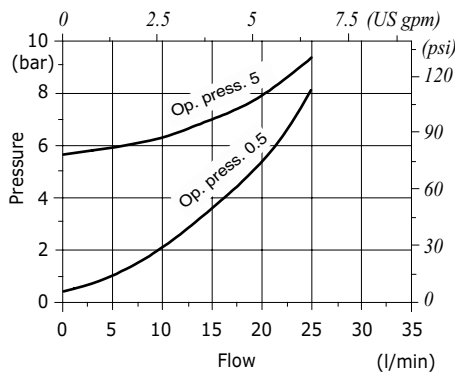

VUI 38 HF pressure drop vs. flow

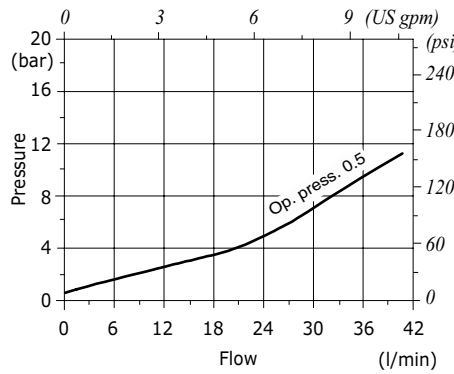

VUI 12 pressure drop vs. flow

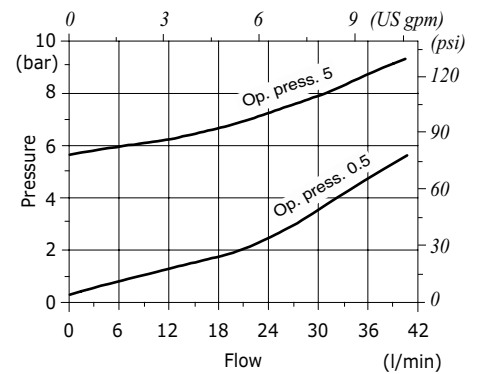

VUI 34 pressure drop vs. flow

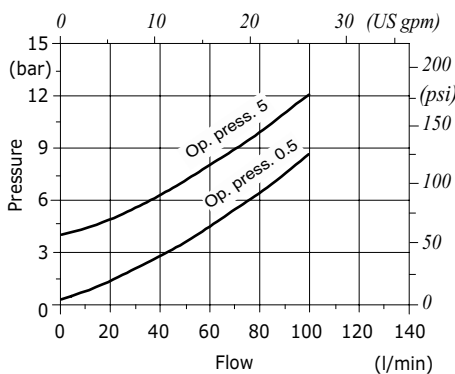

VUI 100 pressure drop vs. flow

