



## Type VUS/INC/B check valves

- Poppet type

Technical specifications and diagrams are measured with mineral oil ISO VG32 at 50°C (122°F) temperature.

	<b>VUS/INC/B14</b>	<b>VUS/INC/B38</b>	<b>VUS/INC/B12</b>
Nominal flow	20 l/min (5.3 US gpm)	50 l/min (13.2 US gpm)	80 l/min (21.1 US gpm)
Max. pressure	350 bar (5100 psi)		
Oil leakage	0.25 cm <sup>3</sup> /min (0.015 in <sup>3</sup> /min) at 210 bar (3050 psi)		
Fluid	mineral based oil		
Viscosity	from 10 to 200 cSt		
Max. level of contamination	18/16/13 ISO4406		
Fluid temperature	with NBR seals: from -20°C (-4°F) to 80°C (176°F)		
Environmental temperature for working conditions	from -40°C (-40°F) to 100°C (212°F)		
Weight	Steel 0.01 kg (0.02 lb)	0.02 kg (0.04 lb)	0.03 kg (0.06 lb)

NOTE - For different conditions, please contact Walvoil Sales Dpt.



### Dimensions

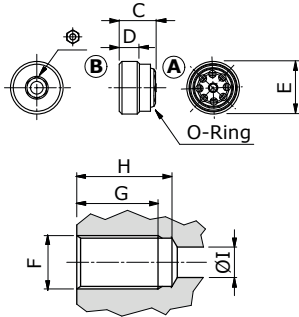

Dimensions are in mm-in

Valve type	ØC	D	E	Ø	O-Ring
<b>VUS/INC/B14</b>	10 - 0.39	6 - 0.24	G 1/4	5	1x9
<b>VUS/INC/B38</b>	11.5 - 0.45	7 - 0.27	G 3/8	6	1.5x10
<b>VUS/INC/B12</b>	13.5 - 0.53	8 - 0.31	G 1/2	8	1.6x14.1

Valve cavity for	F	G	H	ØI
<b>VUS/INC/B14</b>	G 1/4	21.5 - 0.85	24 - 0.94	7 - 0.27
<b>VUS/INC/B38</b>	G 3/8	23 - 0.90	25.5 - 1	9 - 0.35
<b>VUS/INC/B12</b>	G 1/2	28 - 1.10	30.5 - 1.2	12 - 0.47

### Ordering codes and description composition

**VUS/INC/B 14/Pa0,5**

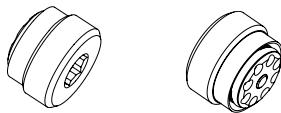

#### Complete valves

TYPE	CODE	DESCRIPTION
<b>VUS/INC/B14/Pa0,5</b>	1312310100	Opening pressure 0.5 bar (7.25 psi), G1/4 thread
<b>VUS/INC/B38/Pa0,5</b>	1312320100	Opening pressure 0.5 bar (7.25 psi), G3/8 thread
<b>VUS/INC/B12/Pa0,5</b>	1312330100	Opening pressure 0.5 bar (7.25 psi), G1/2 thread

For different configurations and SAE thread please contact our Sales Dpt.